

Flower Boxcard and Gift Project

The card folds flat and fits in an A-2 envelope. The box of coordinating cards makes a perfect gift!

Supplies:

- 1 sheet of SU! Designer Series Paper (DSP)
- 1 sheet of white or vanilla cardstock
- 2-1/2 sheets of colored cardstock
- Window Sheet (or clear acetate of some sort)
- 4 SU! Notecards w/ Envelopes (3-1/2" x 5")
- Stampin' Trimmer
- Simply Scored Scoring Tool
- Envelope Punch Board
- Sticky Strip, Glue Dots & Dimensionals
- Stamps & Matching punches (*Flower Shop/ Pansy punch, Petite Petals, Papillon Potpourri/Elegant Butterfly Label LoveArtisan Label*)
- Leaf punch or Framelit
- Greeting stamps
- Rhinestone or Pearl Basic Jewels



Directions:

Step 1: Cut the 12"x12" sheet of DSP as shown in Diagram A below.

Step 2: Score and cut a 5" x 8-1/2" piece of coordinating colored cardstock as shown in Diagram B below.

Step 3: Cut two 1/2" x 3" strips of cardstock and score at 1/2" on each end of the strips as show in Diagram C.

Step 4: Cut the other pieces of white and colored cardstock as shown in Diagrams D, E & F.

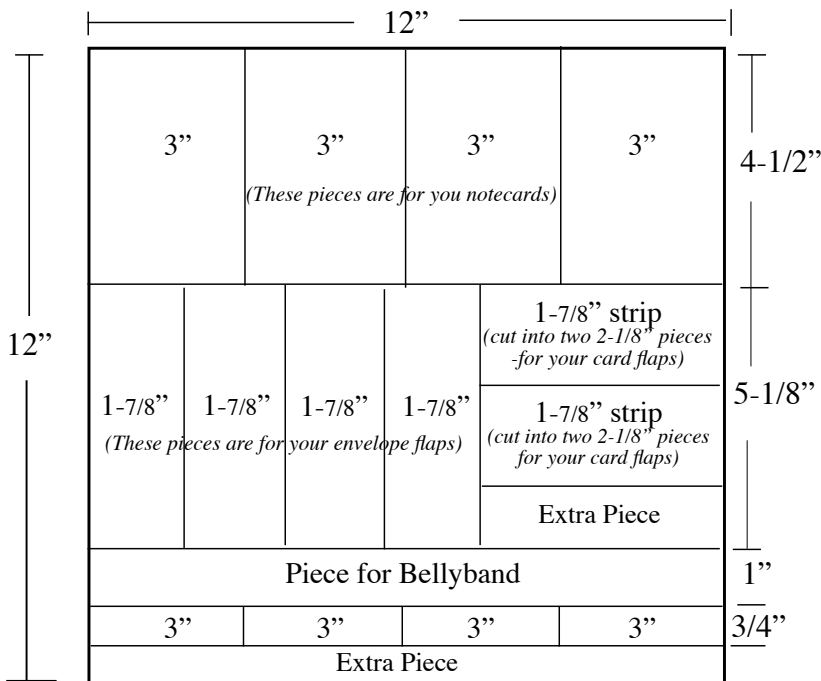

Diagram A

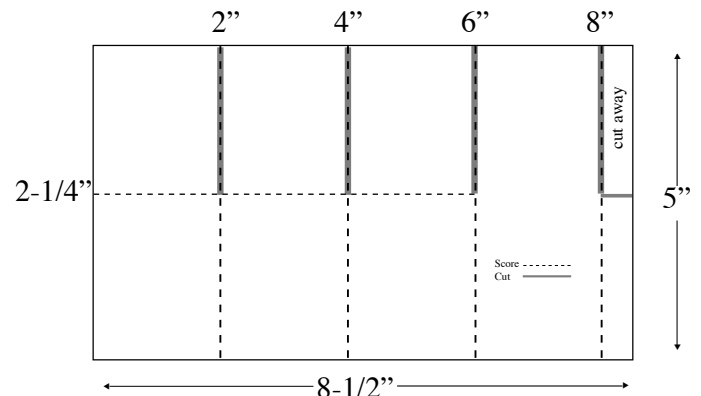

Diagram B

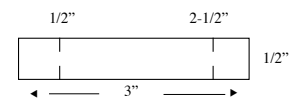

Diagram C

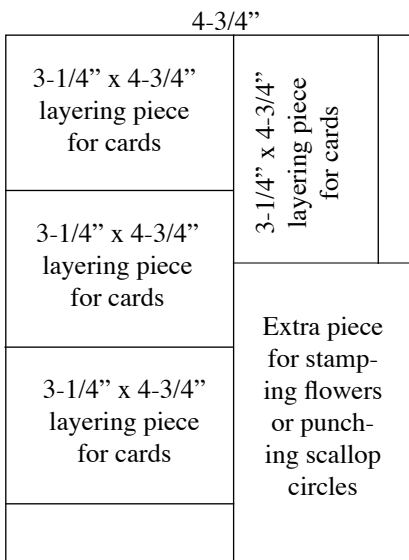

Diagram D
(8-1/2" x 11" Colored Cardstock)

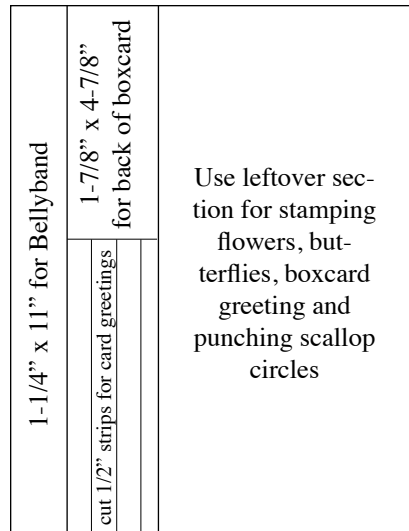

Diagram E
(8-1/2" x 11" White or Vanilla Cardstock)

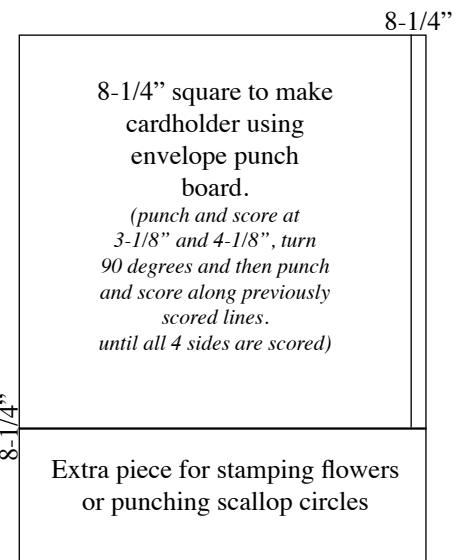
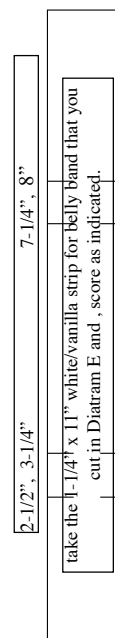
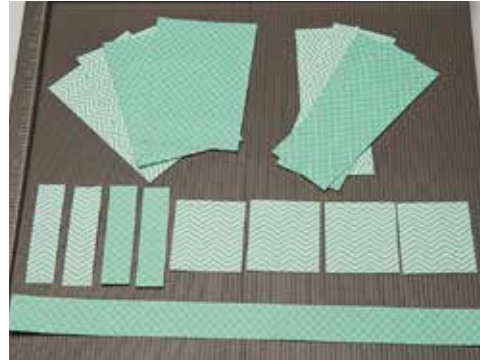
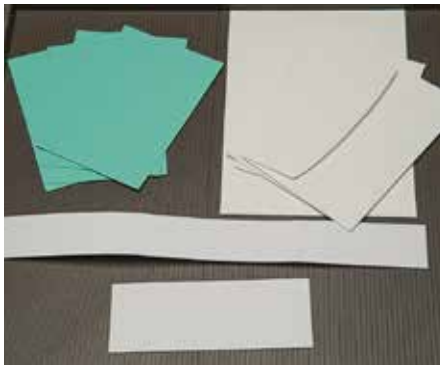
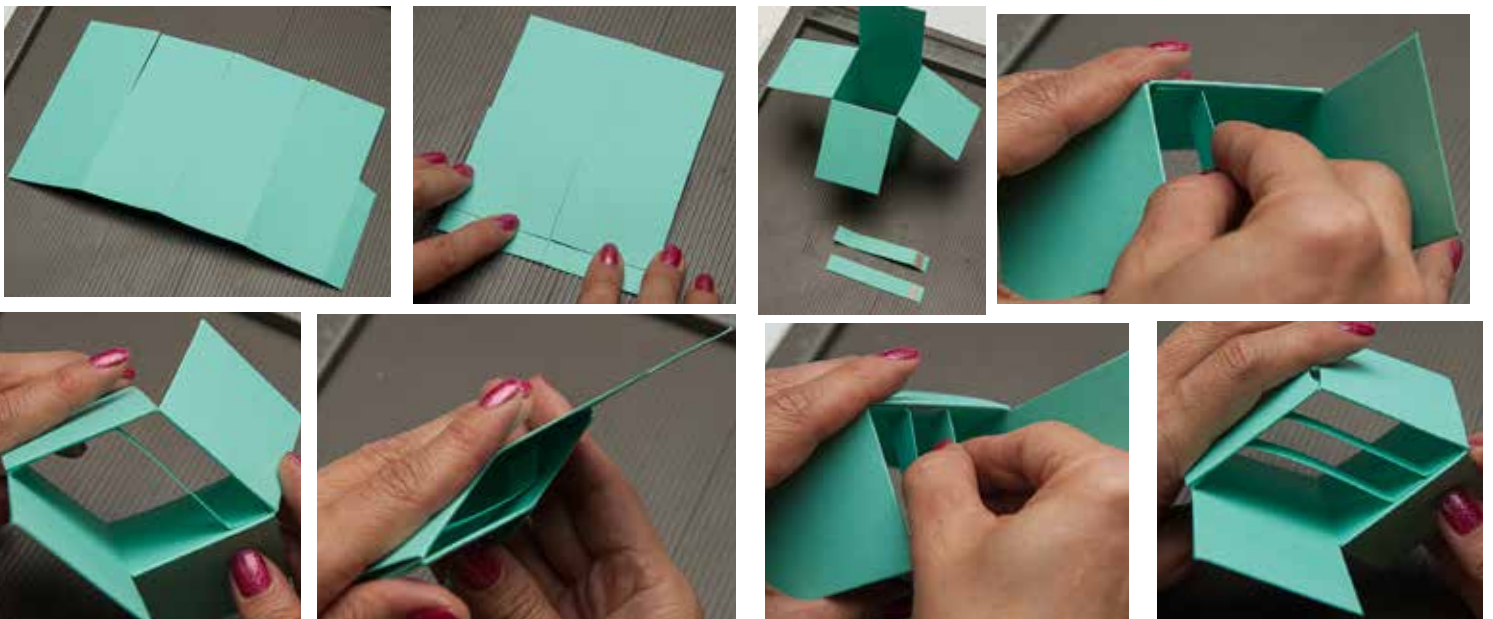

Diagram E
(8-1/2" x 11" Colored Cardstock for cardholder)



- Step 5:** Assemble box along side flap using Sticky Strip. Fold down the flaps of the box at the score lines.
- Step 6:** Place the two 1/2" x 3" pieces from Step 3 into the center of the box using stick strip or glue dots. (*note: I used a z-fold*).
- Step 7:** Adhere the four 1-7/8" x 2-1/8" pieces of DSP and adhere to flaps/back section of card.



Step 8: If desired, stamp and embellish the 1-7/8" x 5-1/8" piece of white or vanilla cardstock and then place the piece on the back of the "box" so you can write a message to the recipient.

Step 9: Stamp & punch flowers, butterflies and greeting as desired and then place at least 3 of the larger flowers onto small strips (approx 1/2" x 2-1/2") of window sheet or cardstock using glue dots. Adhere the now "stemmed" flowers to the strips in the middle of the box. Fill in with leaves and smaller flowers as desired. (Take care that you don't place the flowers too far to the left, right or top of the card edges so as not to make the card too big to put in a standard envelope when folded)..

Step 10: Adhere the butterflies, greeting and then embellish with rhinestones or pearls as desired. Your cardbox is now complete!



Step 11: Take the 8-1/4" square piece of colored cardstock and using the Envelope Punch Board score and punch at 3-1/8" and 4-1/8" along one side. Keep rotating the cardstock and punch and score using the previous score lines as a guide until you get all for sides completed. Round each corner using the rounder on the top of the Punchboard.



Step 12: Cut away two little squares at the top of the envelope card box and then cut just to score line on the bottom squares as shown below. Fold at score lines and assemble using adhesive of choice (*Sticky Strip preferred*).

Step 13: Adhere the 1" x 12" piece of DSP to the scored white Bellyband strip from Diagram E and cut off excess DSP at the end. Fold at score lines and then wrap around the envelope box adhering the ends together using Sticky Strip. Embellish with stamped flower image.

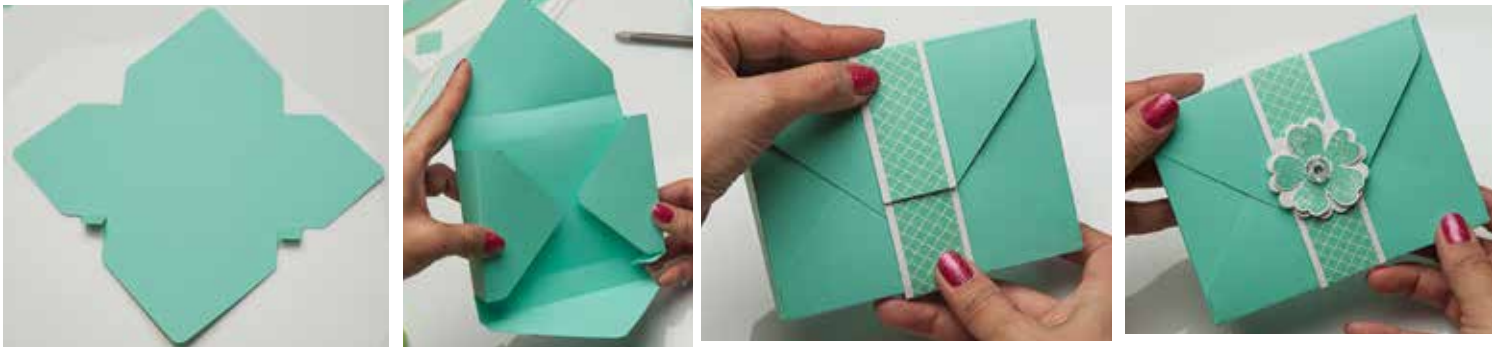

Step 14: Use the 1-7/8" x 5-1/8" pieces of DSP to embellish the flaps of the envelopes using adhesive of choice. Trim away excess to match the flap if desired.

Step 15: Stamp greetings on the 1/2" strips of white cardstock and then assemble the 4 notecards embellishing as desired.

Step 16: Place your cards and envelopes in the cardholder and your project is now complete!!

